

# Quick Installation Guide

AC750 Dual Band Wi-Fi Router

\*Images may differ from the actual product.

## Router Mode

If your internet connection is through an Ethernet cable directly from the wall instead of through a DSL / Cable / Satellite modem, connect the Ethernet cable to the router's **WAN** port, then follow step 4 and 5 to complete the hardware connection.

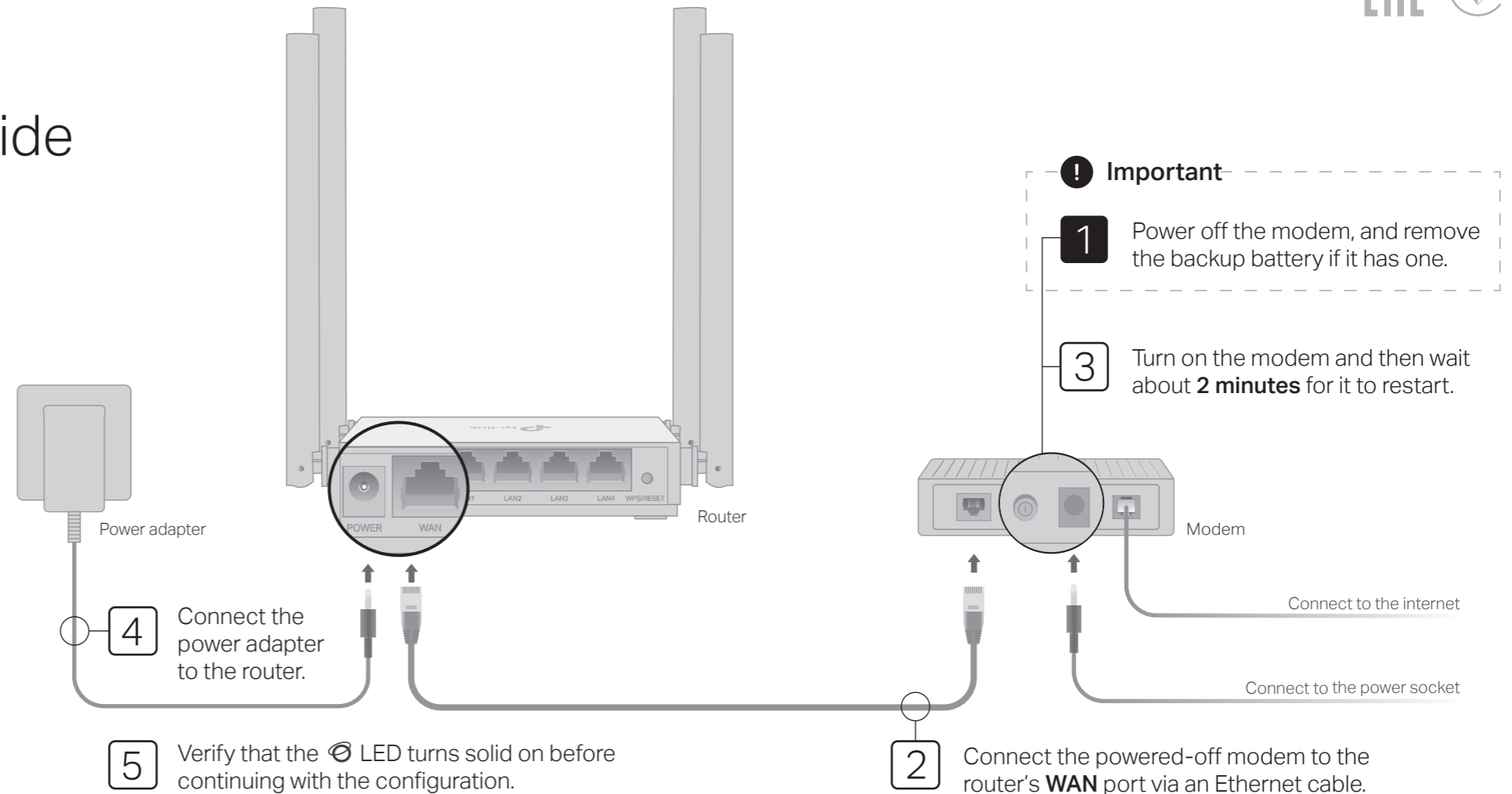

## 6 Configure the router

1. Connect your computer to the router (Wired or Wireless)

### • Wired

Turn off the Wi-Fi on your computer and connect it to the router via an Ethernet cable.

### • Wireless

Connect your device to the router's Wi-Fi using the **SSID** (network name) and **Wireless Password** printed on the label at the bottom of the router.

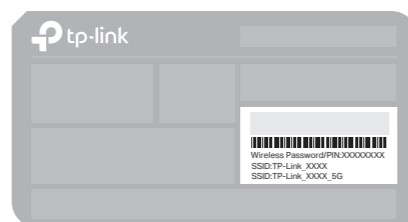

2. Launch a web browser, and enter <http://tplinkwifi.net> or <http://192.168.0.1> in the address bar. Create a password to log in.

Note: If the login window does not appear, please refer to [FAQ > Q1](#).

Browser address bar: <http://tplinkwifi.net>

New Password:

Confirm Password:

3. Follow the step-by-step instructions to set up the internet connection.

Note: If you are not sure of the Connection Type, please click **AUTO DETECT** or contact your ISP (Internet Service Provider) for help.

**Enjoy the internet!**

## Tether App

The TP-Link Tether app provides a simple, intuitive way to access and manage your router. Scan the QR code to download Tether from the Apple App Store or Google Play.



# Access Point Mode

In this mode, the router transforms your existing wired network to a wireless one.

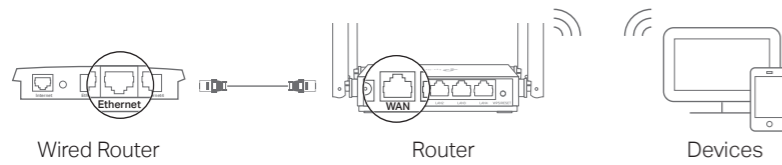

- Power on the router.
- Connect the router's **WAN** port to your wired router's Ethernet port via an Ethernet cable as shown above.
- Connect a computer to the router via an Ethernet cable or wirelessly by using the **SSID** (network name) and **Wireless Password** printed on the label at the bottom of the router.
- Launch a web browser and enter <http://tplinkwifi.net> in the address bar. Create a password to log in.
- Click **Change Mode** in the top right corner and select **Access Point Mode**. Wait for the router to reboot.  
Note: You can also go to **Advanced > Operation Mode** to switch to **Access Point Mode**.
- Use <http://tplinkwifi.net> to log in to the web management page and follow the step-by-step instructions to set up the internet connection.

Enjoy the internet!

# Range Extender Mode

In this mode, the router boosts the existing wireless coverage in your home.

## 1. Configure

- Place the router next to your host router and power it on.
- Connect a computer to the router via an Ethernet cable or wirelessly by using the **SSID** (network name) and **Wireless Password** printed on the label at the bottom of the router.
- Launch a web browser and enter <http://tplinkwifi.net> in the address bar. Create a password to log in.
- Click **Change Mode** in the top right corner and select **Range Extender Mode**. Wait for the router to reboot.  
Note: You can also go to **Advanced > Operation Mode** to switch to **Range Extender Mode**.
- Use <http://tplinkwifi.net> to log in to the web management page and follow the step-by-step instructions to set up the internet connection.

## 2. Relocate

Place the router about **halfway** between your host router and the Wi-Fi "dead" zone. The location you choose must be within the range of your existing host network.

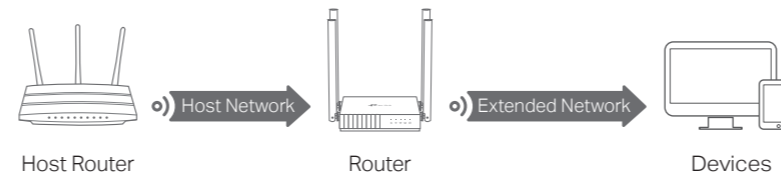

Enjoy the internet!

# Appearance

Item	Description
Power	<b>Green</b> <ul style="list-style-type: none"> <li><b>Solid on:</b> Power is on.</li> <li><b>Blinking slowly:</b> The system is starting up or firmware upgrade is in progress.</li> <li><b>Blinking quickly:</b> WPS connection is in progress.</li> </ul>
2.4GHz	<b>Green</b> <ul style="list-style-type: none"> <li><b>Solid on:</b> The 2.4GHz wireless band is enabled.</li> </ul>
5GHz	<b>Green</b> <ul style="list-style-type: none"> <li><b>Solid on:</b> The 5GHz wireless band is enabled.</li> </ul>
LAN	<b>Green</b> <ul style="list-style-type: none"> <li><b>Solid on:</b> At least one LAN port is connected.</li> </ul>
Internet	<ul style="list-style-type: none"> <li><b>Orange:</b> Router Mode: The WAN port is connected, but internet is not available.</li> <li><b>Green:</b> <ul style="list-style-type: none"> <li><b>Solid on:</b> Router Mode: Internet is available.</li> <li>Access Point Mode: The WAN port is connected.</li> <li>Range Extender Mode: The router is connected to the host network.</li> </ul> </li> </ul>
WPS/RESET Button	Press for 1 second to enable the WPS function. Press and hold the button until all LEDs turn off to reset the router to its factory default settings.

# FAQ (Frequently Asked Questions)

## Q1. What can I do if the login window does not appear?

- Reboot your router and try again.
- If the computer is set to a static IP address, change its settings to obtain an IP address and DNS server address automatically.
- Verify that <http://tplinkwifi.net> or <http://192.168.0.1> is correctly entered in the web browser. Alternatively, enter <http://192.168.1.1> in the web browser and press **Enter**.
- Use another web browser and try again.
- Disable and then enable the network adapter being used.

## Q2. What can I do if I cannot access the internet when in Router mode?

- Reboot your modem and router, then try again.
- Check if the internet is working normally by connecting a computer directly to the modem using an Ethernet cable. If it is not, contact your Internet Service Provider.
- Log in to the web management page of the router, and go to the **Network Map** page to check whether the WAN IP address is valid or not. If it is not, check the hardware connection or contact your internet service provider.
- For cable modem users, log in to the web management page of the router. Go to **Advanced > Network > Internet** and locate the **MAC Clone** section. Select **Clone Current Device MAC**, and click **SAVE**. Then reboot both the modem and the router.

## Q3. How do I restore the router to its factory default settings?

- With the router powered on, press and hold the **WPS/RESET** button on the back panel of the router until all LEDs turn off. The router will reboot.
- Log in to the web management page of the router. Go to **Advanced > System > Backup & Restore** (or **System > Backup & Restore** in Access Point Mode or Range Extender Mode), and locate the **Factory Default Restore** section. Then Click **FACTORY RESTORE**. The router will restore and reboot automatically.

## Q4. What can I do if I forgot my web management password?

- Refer to **FAQ > Q3** to reset the router, then create a password to log in.

## Q5. What can I do if I forgot my wireless network password?

- The factory default wireless password is printed on the label of the router.
- Connect a computer directly to the router using an Ethernet cable. Log in to the router's web management page, and go to **Wireless** to obtain or reset your wireless password.

## Safety Information

- Keep the device away from water, fire, humidity or hot environments.
- Do not attempt to disassemble, repair, or modify the device.
- Do not use damaged charger or USB cable to charge the device.
- Do not use any other chargers than those recommended.
- Do not use the device where wireless devices are not allowed.
- Adapter shall be installed near the equipment and shall be easily accessible.

To ask questions and communicate with TP-Link users or engineers, please visit <https://community.tp-link.com> to join TP-Link Community.

If you have any suggestions or needs on the product guides, welcome to email [techwriter@tp-link.com.cn](mailto:techwriter@tp-link.com.cn).

For technical support, the user guide and more information, please visit <https://www.tp-link.com/support/>, or simply scan the QR code.

